

Hinge & Handle Hole Drilling Machine

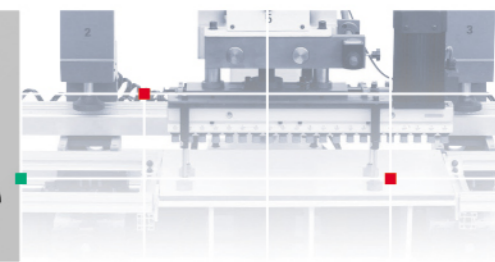

MB2051

Hinge & Handle Hole Drilling Machine

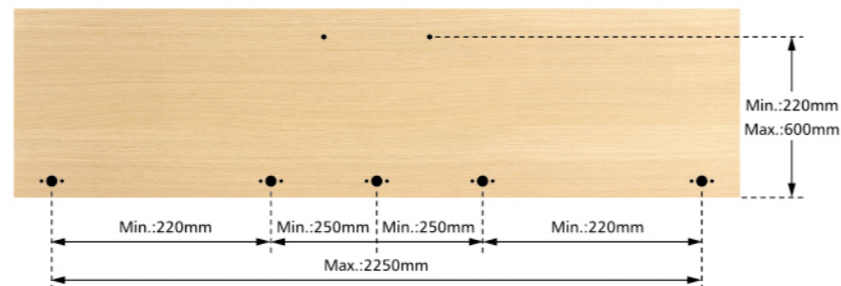
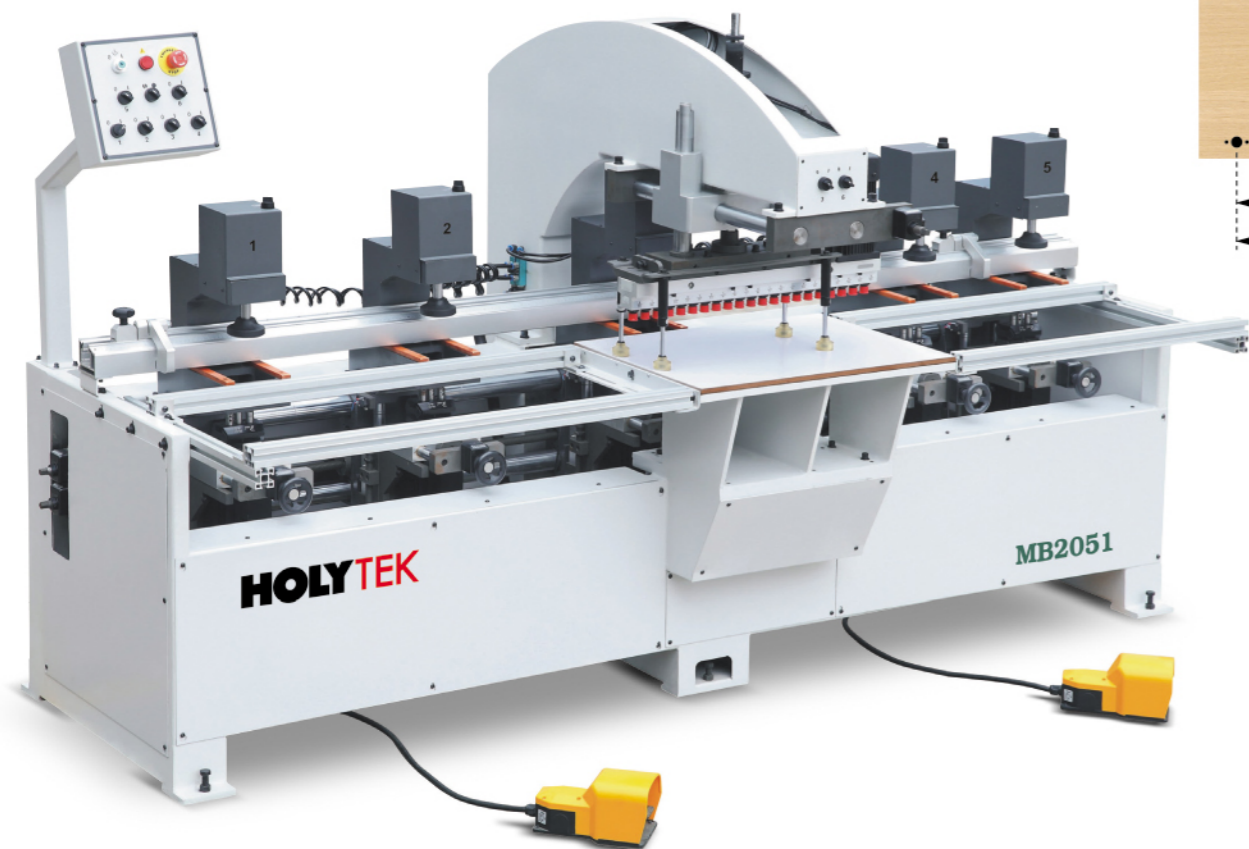

MB2051 drill style

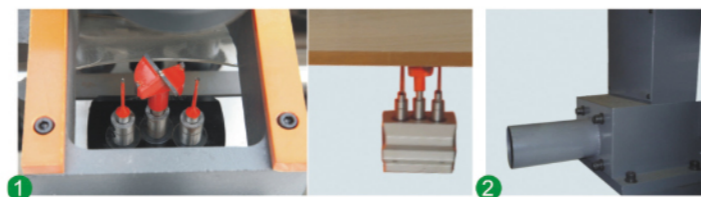

- ① Drilling from bottom of board, keep board clean without dust
- ② With dust collection hole, can clean dust easily

MB2041

Hinge & Handle Hole Drilling Machine

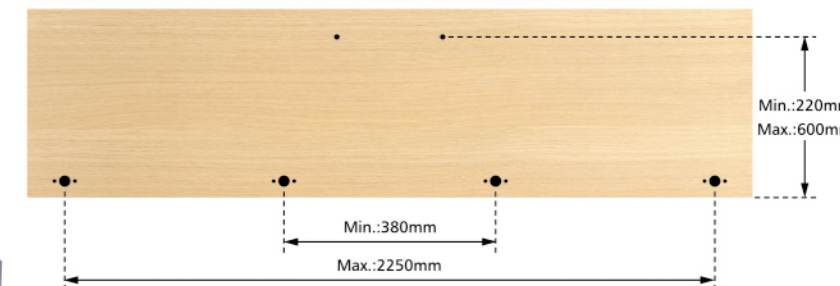
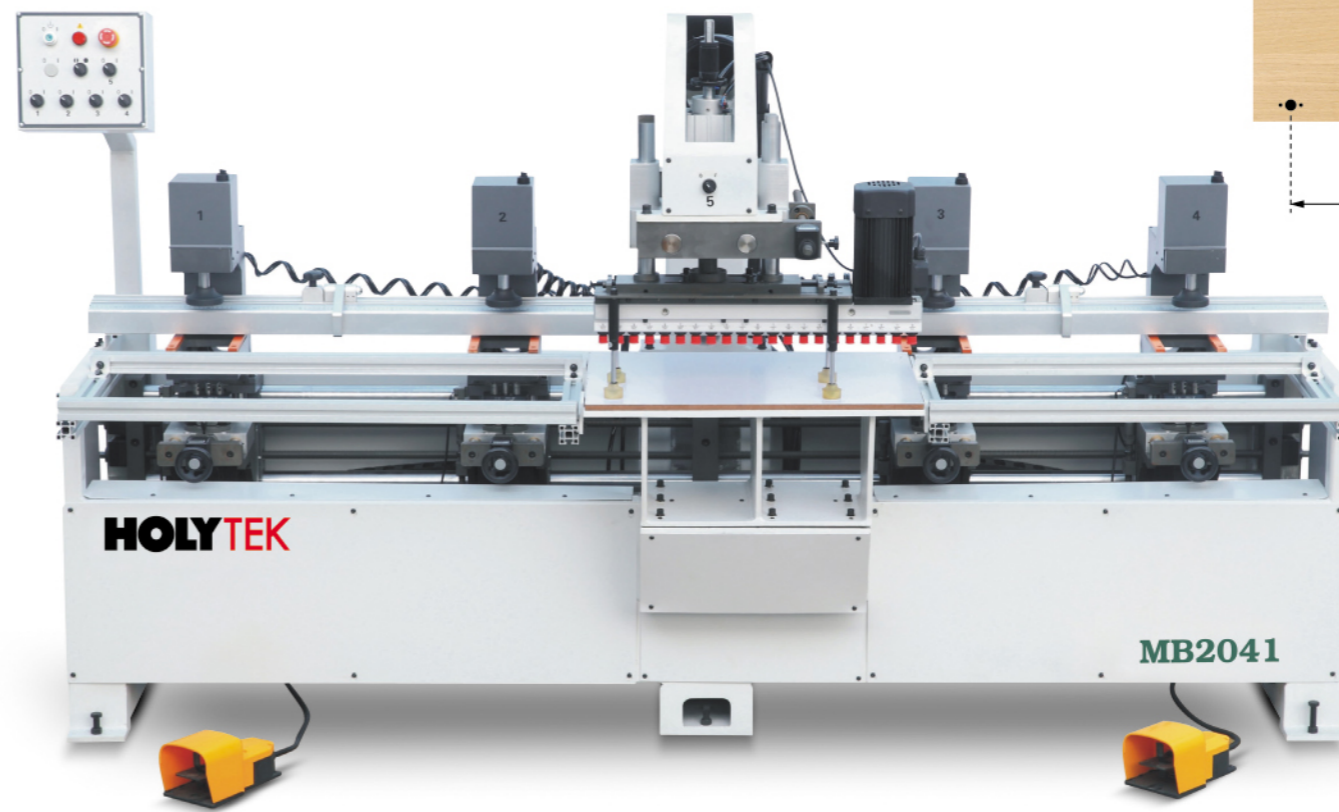

MB2041 drill style

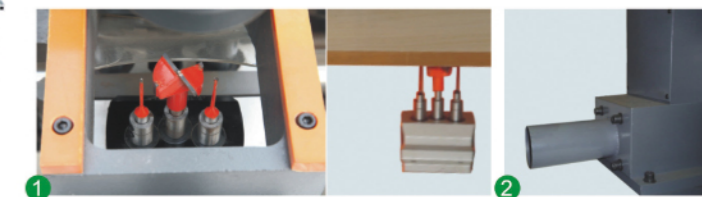

- ① Drilling from bottom of board, keep board clean without dust
- ② With dust collection hole, can clean dust easily

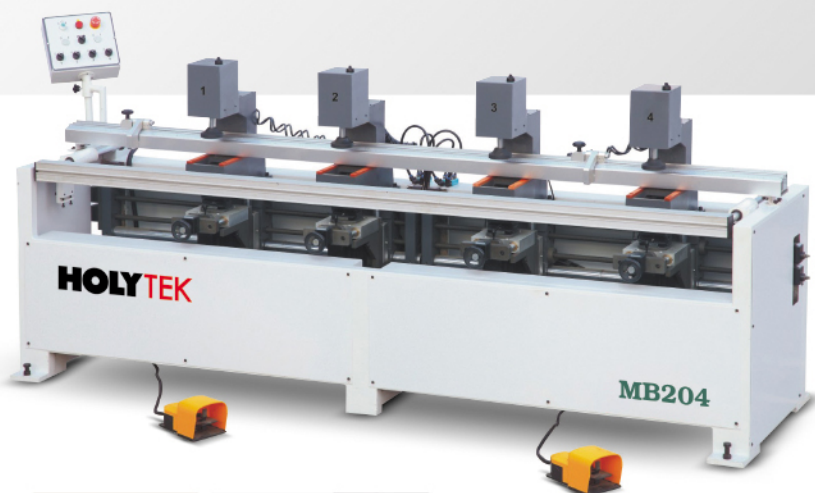

MB204 (optional: MB205)
Hinge Drilling Machine



MB202 Hinge Drilling Machine

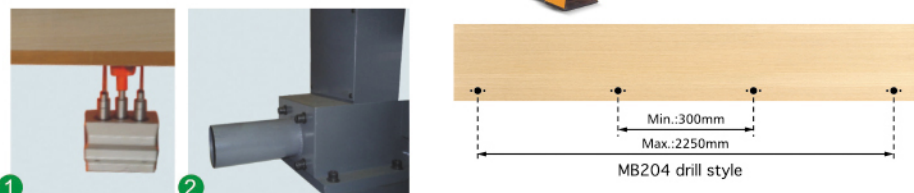

- ① Drilling from bottom of board, keep board clean without dust
- ② With dust collection hole, can clean dust easily

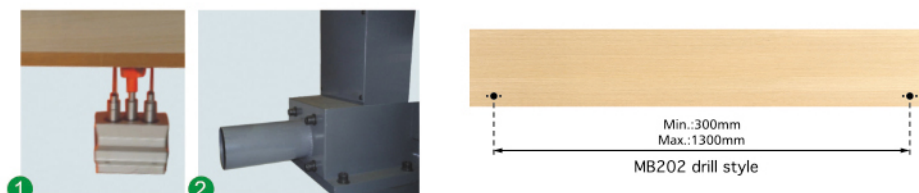

- ① Drilling from bottom of board, keep board clean without dust
- ② With dust collection hole, can clean dust easily



MB201 Hinge Drilling Machine

Technical Data

Model	MB201 (single-head)	MB202 (double-head)	MB204/MB205 (four/five-head)	MB2041 (4+1 head)	MB2051 (5+1 head)
Table size (mm)	350x1000	(380~670)x1800	(380~670)x2720	(380~670)x2720	(380~670)x2720
Total power (kw)	1.1	2.2	4.4/5.5	5.9	7
Qty of drilling unit (set)	1	2	4/5	4+1	5+1
Main spindle speed (r/min)	2800	2800	2800	2800	2800
Drilling depth (mm)	50	50	50	50	50
Compress air pressure (MPa)	0.6~0.8	0.6~0.8	0.6~0.8	0.6~0.8	0.6~0.8
Net weight (kg)	250	510	760/850	880	950